

BLUEMILLA ESSENTIAL

Lubricating ophthalmic solution
10 ml sodium hyaluronate at 0.15%

Bluemilla essential is a sterile hypotonic eye solution, containing sodium hyaluronate at 0.15% without preservatives and phosphates. The sodium hyaluronate contained in the product is obtained by fermentation and it is not of animal origin.

Bluemilla essential maintains and restores the physiological conditions of the eye surface, protects its cells and induces a long lasting comfort. *The slight hypotonia (about 270 mOsm), and the pH (the physiological value is about 7.2) help to maintain the optimal conditions for preserving the health of the ocular surface (optional text).*

INDICATIONS

Treatment of the dry eye symptoms.

Bluemilla essential brings prompt and lasting relief in case of sensation of dryness, irritated and tired eyes caused by dry eye diseases and by external factors such as prolonged exposure to video screens, air conditioning, dust, pollution, smoke, etc.

Bluemilla essential is indicated for both wearers of all types of corrective contact lenses and non-wearers.

COMPOSITION

Sodium Hyaluronate 0,15 %, Sodium chloride, Boric Acid, Borax, Purified Water.

INSTRUCTION FOR USE

- Wash and rinse your hands thoroughly.
- Remove the tamper-evident seal.
- Remove the protective cap. Make sure that the tip of the bottle does not touch your fingers.
- Lean your head back slightly and pull your lower eyelid down slightly with a finger of your free hand and hold the bottle vertically above your eye with the nozzle pointing downwards. Then gently squeeze the bottle to apply one or two drops into each eye, or according to the specialist's advice. Avoid contact of the top of the bottle with your eye or your fingers to prevent any possible contamination of the solution.
- Replace the protective cap after use.
- The product can be used as often as needed.

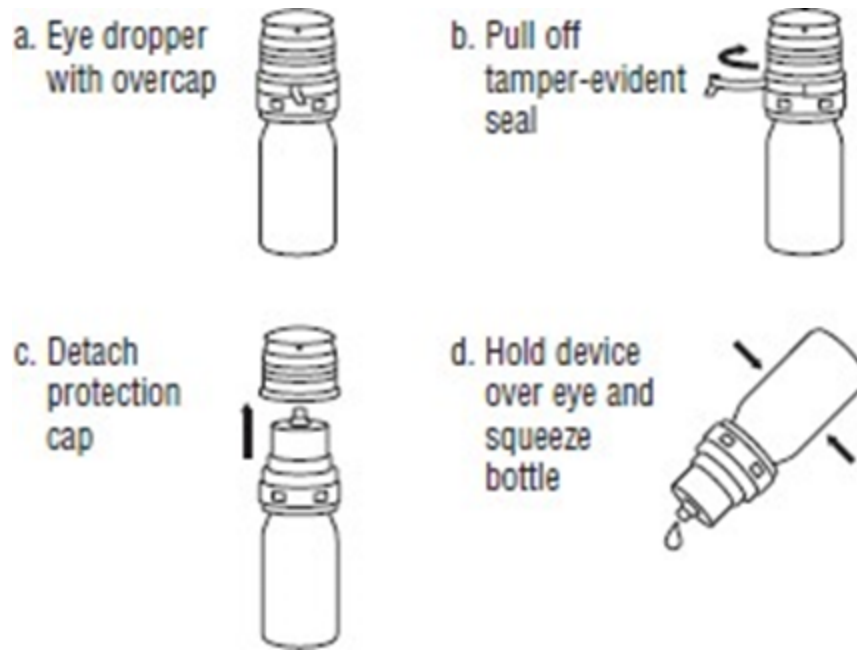

WARNINGS AND PRECAUTIONS

- Do not use it if the bottle is damaged.
- Do not share the bottle to prevent cross contamination.
- If you have to apply additional treatments to the eye, an application interval of at least 15 minutes should be left between the two medications.
- To prevent possible contamination, do not let the tip of the dropper come into contact with any surface.
- Do not use it if you are hypersensitive (allergic) to any of the constituents.
- Rare cases of mild eye irritation are possible after product instillation. Stop using it if you experience pain, redness or any change in vision following the installation. Ask a doctor for advice if the symptoms persist or get worse.
- If you experience blurred vision after application, wait until your vision is clear before driving or using tools or machinery.
- Do not swallow the solution.
- Keep out of reach of children.
- If you experience a persistent problem, please consult your doctor/optician.
- Do not instill TBX 112 in the eye(s) together with other substances as their effect may be altered.

VALIDITY

Do not use the solution after the expiry date.

PACKAGE

10 ml fill volume into a multidose ophthalmic container.

STORAGE CONDITIONS

- Store the bottle at a temperature below 30°C.

- After the bottle has been opened, the solution must be used within 90 days. Any residual product must be disposed of.



Tubilux Pharma S.p.A
Via Costarica 20/22 00071 Pomezia (RM) Italy
MEDICAL DEVICE

DISTRIBUTED BY:
.....
.....

Last Revision Rev.03 of 09/2016



C.O.C. Farmaceutici srl
Via Modena, 15
40019 - S. Agata Bolognese (BO) ITALIA
Via Chiesa Sud, 156 C/D/E/F/G
41016 - Rovereto s/S - Novi di Modena (MO) ITALIA

Cap. Soc. € 1.200.000 I.V.
C.F. e Iscr. Reg.
Impr. di Bologna 03541870378
P.IVA IT 01603491208
R.E.A. Bologna N. 299432



Tubilux Pharma S.p.A.
Via Costarica, 20/22
00071 Pomezia (Roma)
ITALIA

cap. soc. € 472.500,00 I.V.
C.F. / P.IVA 05406661008
R.E.A. Roma N. 883476